

BARTON CREEK

HOLE	1	2	3	4	5	6	7	8	9	OUT	I	10	11	12	13	14	15	16	17	18	IN	TOT	HCP	NET
BLACK ■ 75.4/138	403	383	173	330	596	449	543	212	457	3546	N	450	192	392	357	545	457	452	209	561	3615	7161		
GOLD □ 73.8/132	395	369	165	320	554	423	530	204	428	3388	T	441	175	385	350	527	445	418	188	555	3484	6872		
BLUE □ 72.0/129	371	348	155	298	525	407	520	178	418	3220	I	401	164	360	321	499	429	387	182	541	3284	6504		
WHITE □ M 70.2/127 W 76.4/139	351	338	140	276	507	373	512	154	404	3055	A	393	144	346	306	464	415	349	161	467	3045	6100		
PAR	4	4	3	4	5	4	5	3	4	36	L	4	3	4	4	5	4	4	3	5	36	72		
HANDICAP	15	9	17	11	5	3	7	13	1			2	18	14	16	12	4	6	10	8				
+/-																								
RED □ 70.6/121	277	288	110	264	420	343	434	126	312	2574		372	125	255	244	415	372	277	117	398	2575	5149		

Scorer:

Attest:

Date:

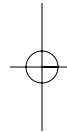

LOCAL RULES & COURTESY OF PLAY

- Golf rules of the USGA govern all play.
 - Please replace divots, repair ball marks and rake bunkers.
 - Avoid all sensitive growth areas.
 - The embedded ball rule is in effect through the green.
 - Observe 90° cart rule at all times, unless otherwise specified.
 - Keep carts on surfaced paths around all tees and greens.
 - Yardages on sprinkler heads are to the center of greens.
 - Attire specifically designed for golf is required.
 - Golf shoes must be equipped with non-metal spikes only.
 - All golfers must adhere to the rules set forth by the golf professional.
- Expected pace of play is a maximum of 4 hours. Course Marshals have full discretion to help accommodate this pace.
- Flags and fairway yardage plates color-coded. Yellow-250 yards, Blue-200 yards, White-150 yards, Red-100 yards.
- Flags: Red-front, White-middle, Yellow-back.

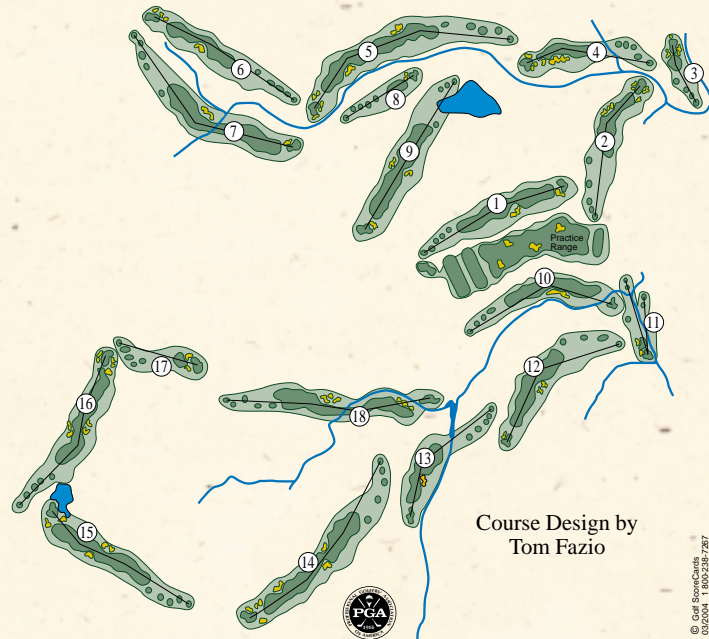

FAZIO CANYONS

AT

BARTON CREEK COUNTRY CLUB

© Golf ScoreCards Inc.
do not duplicate